

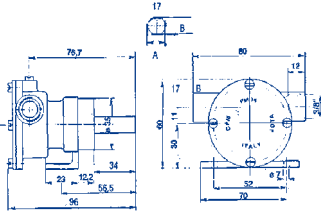

Pompe autoadescenti in bronzo, girante in neoprene, per raffreddamento motori. Le portate sono calcolate con motore a 700/2000 giri.



16.00014
PM 15 Bocche da 3/8, portata lt./min. 15/26

27.27120 Girante per PM15

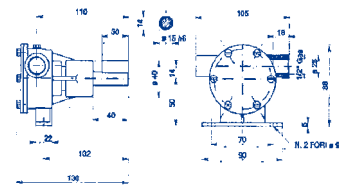

16.00016
PM 16 Bocche da 1/2, portata lt./min. 17,5/50

27.27162 Girante per PM16

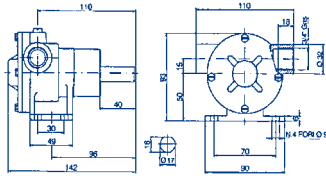

16.00034
PM 34 Bocche da 3/4, portata lt./min. 18/49

27.27105 Girante per PM34

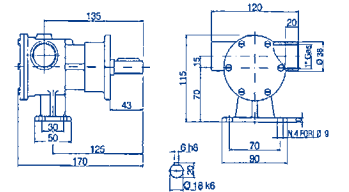

16.00036
PM 36 Bocche da 1', portata lt./min. 28/96

27.27104 Girante per PM36

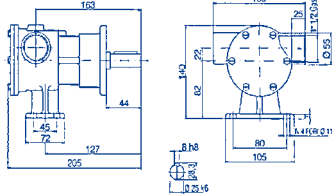

16.00040
PM 40 Bocche da 1' 1/2, portata lt./min. 95/293

27.27103 Girante per PM40

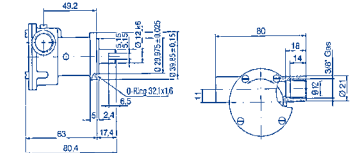

16.00114
ST114 Bocche da 3/8, portata lt./min. 7/14 per motori Volvo Penta, Bukh, Arona, Ducati, Ruggerini, Nanni ecc...

27.27120 Girante di ricambio per ST114

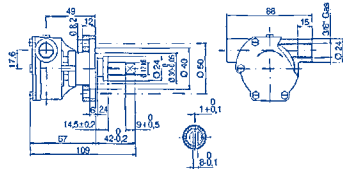

16.00134
ST134 Bocche da 3/8, portata lt./min. 13/28 per motori Vetus M.

27.27109 Girante di ricambio per ST134

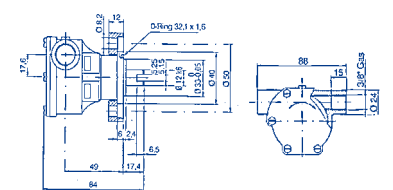

16.00135
ST135 Bocche da 3/8, portata lt./min. 13/28 per motori Ruggerini, Lombardini, Nanni, Mitsubishi, Lister Petter, Watermota.

27.27101 Girante di ricambio per ST135

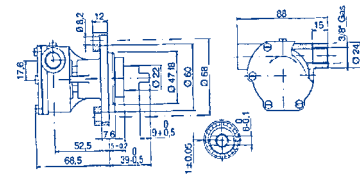
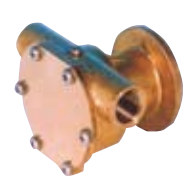

16.00136
ST136 Bocche da 3/8, portata lt./min. 13/28 per motori Vetus K.

27.27101 Girante di ricambio per ST136

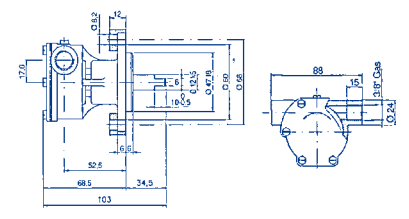

16.00137
ST137 Bocche da 3/8, portata lt./min. 13/28 per motori Nanni FK2/ FK3, Aifo, Mitsubishi.

27.27101 Girante di ricambio per ST137

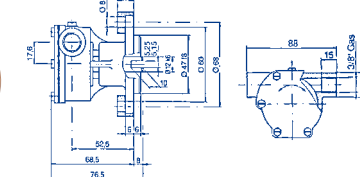

16.00138
ST138 Bocche da 3/8, portata lt./min. 13/28 per motori Lombardini LDW 903, Aifo 4041, Volvo Penta AQ-BB-MB-MDI-2000

27.27109 Girante di ricambio per ST138

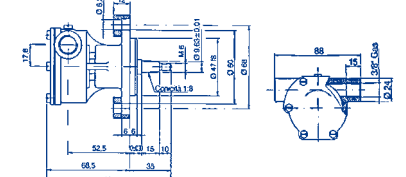

16.00139
ST139 Bocche da 3/8, portata lt./min. 13/28 per motori Lombardini, Aifo.

27.27109 Girante di ricambio per ST139

COMPARAZIONE POMPE RAFFREDDAMENTO MOTORI

AIFO				
ARTICOLO	ANCOR	RIF. MOTORI	RIF. JABSCO	RIF. JOHNSON
16.00137	ST137	402M17 - 403M25 - 404M33 - 414M48	29470-2231C/ 29470-2531C/ 29470-2431C/ 29470-2331	F4B9-10-35127-2
16.00138	ST138	4021M15 - 4021M20 - 4031M25 - 4041M33 - 4041M33 - 4141M48 - 4241M41	29470-2531 / 29470-2231	F4B-9-10-35098-2
16.00139	ST139	4041M33 - 4041M48	29470-2431	FAB-9-10-35355-01
16.00140	ST140	804AM/M - 8041M/SM - 8041SRM - 8060AM/M - C03M/SM - CP3M - 8061M - 8061SM20	3270-241/ 3270-200	F5B9-10-24119-2
16.00149	ST149	CO3M -CO3SM - CP3M - 804AM - 8041M - 8041SM - 8041SRM - 806AM - 806M - 8060SRM25 - 8060SM21 - 8061M - 8061SM20	29500-1001/ 3270-200	F7B-9-10-24014-1 - F5B-9-10-24119-2
16.00150	ST150	806SM - 8060MSD - 8061SM/SRM - 821M - 8220M/SM - 8361SRM - CO3M - CP3M/SM - 836MTCA - 836SM - 836SRM - 8061SRM - 8141SRM - 8141SM11 - 821 - 8210 - 8220 - 8280M - 8361M - 8361SM - 8361SRM	9700-200 / 29600-1201/ 9700-21/ 29500-1001	F7B-9-10-24014-1/ F5B-9-10-24119-2
ARONA				
ARTICOLO	ANCOR	RIF. MOTORI	RIF. JABSCO	RIF. JOHNSON
16.00114	ST114	AD190 - AD195M - AD295M	22230-200	F35B-9-10-35157-5 /1/3
16.00140	ST140	AD395 - AD4100M	3270-241	F5B9-10-24119-2
16.00014	PM15	AD182L/M - AD185M - AL186 - AD195M/R	52010-2001/ 29300-2401/ 11620-211	F35B-8-10-35038-1/9
16.00034	PM34	AD495	21080-204	F5B-8-10-24073-1
BUCK				
ARTICOLO	ANCOR	RIF. MOTORI	RIF. JABSCO	RIF. JOHNSON
16.00114	ST114	DV10LME/LSME/M - DV18LME/SLME - DV20ME/SME - DV24ME/SME - DV8ME/SME	22230-200/ 29300-2101C	F35B-9-10-35157-5 /1/3
CATERPILLAR				
ARTICOLO	ANCOR	RIF. MOTORI	RIF. JABSCO	RIF. JOHNSON
16.00040	PM40	3208	52200-2051	F8B-8-10-13021-1
LISTER PETER				
ARTICOLO	ANCOR	RIF. MOTORI	RIF. JABSCO	RIF. JOHNSON
16.00135	ST135	LPW2/3 (MATEMAR ALPHA 30 - ALPHA 20)	29470-2231	F35B-9-10-31934-1
FARYMAN				
ARTICOLO	ANCOR	RIF. MOTORI	RIF. JABSCO	RIF. JOHNSON
16.00137	ST137	FK3	29470-2331/ 29470-2031	F4B-9-10-35127-2
16.00014	PM15	A30M - A40M - K34 - L30M - RM30M - SM30H - CS	52010-2001/ 29300-2401/ 11620-211	F35B-8-10-35038-1/9
FORD				
ARTICOLO	ANCOR	RIF. MOTORI	RIF. JABSCO	RIF. JOHNSON
16.00140	ST140	FSD425A/TRANSIT (LEHMAN 4D50 - 4D61)	3270-241	F5B9-10-24119-2
LOMBARDINI				
ARTICOLO	ANCOR	RIF. MOTORI	RIF. JABSCO	RIF. JOHNSON
16.00138	ST138	LWD404 - LWD502/1 - LWD503 - LDW602 - LDW903M - LDW1204M - 4031M25	29470-2531 / 29470-2231	F4B-9-10-35098-2
16.00139	ST139	LWD1204SD - LDW1503 - LDW1904M - LDW1904CHD - LDW2004 - LDW2004CHD	29470-2431	FAB-9-10-35355-01
MAN				
ARTICOLO	ANCOR	RIF. MOTORI	RIF. JABSCO	RIF. JOHNSON
16.00150	ST150	DO826GLE40 /ML	9700-200 / 29600-1201	F7B-9-10-24014-1/ F5B-9-10-24119-2
16.00040	PM40	W3V17.5 - W3V22A	52200-2051/ 5400-205	F8B-8-10-13021-1

MITSUBISHI				
ARTICOLO	ANCOR	RIF. MOTORI	RIF. JABSCO	RIF. JOHNSON
16.00135	ST 135	K2C - K3M	29470-2231/ 29470-2351	F35B-9-10-31934-1
16.00137	ST 137	K2C - K3M - K 3 E - K 4 E	29470-2331/ 29470-2351	F4B-9-10-35127-2
16.00138	ST138	K2C	29470- 2531/29470-2351	F4B-9-10-35098-2
16.00146	ST146	S4E2	23430-1041	
16.00149	ST149	S6E2 - K3E - K3EH - K3EM	29500-1001/ 23430-1041/ 23430-1001/ 29400-1101	
NANNI				
ARTICOLO	ANCOR	RIF. MOTORI	RIF. JABSCO	RIF. JOHNSON
16.00135	ST135	Base Kubota 2.60HE - 3.90M - 3.90HE	29470-2231/ 29470-2031C	F35B-9-10-31934-1
16.00137	ST137	Base Kubota 2.60HE - 3.90M - 3.90HE - F K 3	29470-2331/ 29470-2031C	F4B-9-10-35127-2
16.00140	ST140	4.110L - 4.180 - MB180 - MB220 - MB300 - 4.195HE - 4.150HE - 4.108M - 3.100HE	3270-241/ 3270- 261/ 29500-1001/ 3270-200	F5B-9-10-24119-2
16.00143	ST143	3.110HE - 4.110 - 4.150HE - 4.190HE - Dis. NANNI 301725	29500-1501	F5B-9-10-24334-01
16.00146	ST146	4.220HE - 4.340TDI - 4.440HE - 4.440ESC - 5.280HE-6.280-OM366	23430-1001/ 23340-1101	
16.00149	ST149	MB180 - MB300	29500-1001	
16.00014	PM15	A30 - K 34 - L 30 - P 30 - R 30 - S 30	52010-2001/ 29470-2031	
16.00036	PM36	6.570 - 6.570 T	52080-2001/ 6420- 2041/ 52080-2041	F7B-3000-10- 24209-1
16.00040	PM40	1300 - 1600	52200-2051/ 52220-0041/ 52220-0011	F8B-8-10-13021-1
PERKINS				
ARTICOLO	ANCOR	RIF. MOTORI	RIF. JABSCO	RIF. JOHNSON
16.00140	ST140	4.108M - 4.108LL - 4.236LL - 4.238LL	3270-241/ 3270- 200/ 29500-1001/ 10970-21	F5B-9-10-24119-2
16.00149	ST149	4.99M-Prima-4.107 - 4.108M - 4.108LL - 4.236LL - 4.238LL - 6.354M	29500-1001/ 3270- 200/ 3370-200/ 9970-200/ 9700-01	
16.00150	ST150	PRIMA - PRIMERA MD42	9700-200/ 29540- 1001	F7B-9-10-24014-1
16.00212	PFF12	M 20 - 4.99M - 4.107M - 4.236M	29350-1101/ 29350-1001/ 29500-1001/ 3270-200/ 10970/ 9970-200	F4B-9-10-24335-01
16.00036	PM36	S 6 M - 3.152 - 3.1524	52080-2001/ 6420- 2001	F7B-3000-10- 24209-1
RUGGERINI				
ARTICOLO	ANCOR	RIF. MOTORI	RIF. JABSCO	RIF. JOHNSON
16.00114	ST114	CRD100 - CRD951 - MM191 - PM100/2 - PM105/2 - RD100/2 - RD100/951 - RDM901 - RM80 - RM90	22230-200/ 11260- 2101/ 29300- 2201C	F35B-9-10-35157-3
16.00135	ST135	MM351	29470-2231/ 11260-2101/ 29300-2201C	F35B-9-10-31934-1
16.00138	ST138	RM270	29470-2531/ 29470-2231	F4B-9-10-35098-2
16.00140	ST140	PM105/2 - RDM901/2	3270-241/ 11260- 2101/ 29300- 2201C	F5B-9-10-24119-2

VETUS				
ARTICOLO	ANCOR	RIF. MOTORI	RIF. JABSCO	RIF. JOHNSON
16.00134	ST134	M3.10 - M2.04 - M2.05 - M2. 6 - M4 .14	23480-2031/29480-2031C/ 29460-1201/ 3270-2301	F5B 9-10-35100-01
16.00136	ST136	K3 - K3D - K4D	29470-2131	F4B-9-10-35161-1
VM				
ARTICOLO	ANCOR	RIF. MOTORI	RIF. JABSCO	RIF. JOHNSON
16.00140	ST140	103MH11-103MH / SV104MH11-104MH11 / SV-106MH11-106MH / SV804M - 806M	3270-241/ 29500-1001/ 3270-200	F5B-9-10-24119-2
16.00146	ST146	HR488HT - HR488HT9 - HR492H9 - HR482HT9 - HR592H9 - HR592HT9 -HR688HT9 - HR692H9 - HR692HT9	23430-1001	
16.00149	ST149	804 - 806M - 116DAN / M - 103 - 104 MH11SV- 106MH11	29500-1001/ 3270-200/	
VOLVO PENTA				
ARTICOLO	ANCOR	RIF. MOTORI	RIF. JABSCO	RIF. JOHNSON
16.00114	ST114	MB10A - MB11A - MD1 - MD1A - MD1B - MD1KHD - MD1HY - MD2 - MD2B - MD2HBY - MD5A-MD5B-MD5C - MD6A - MD6B - MD7A - MD7B - MD11C - MD11D	22230-200	F35B-9-10-35157-3
16.00138	ST138	AQ60F - AQ90 - AQ95 - AQ95A - AQ110 - AQ115A /B - AQ120A /B /C - AQ125A /B - AQ130 /A /B - AQ130C /D - AQ131A /B /C - AQ140 - BB30 - BB100 - BB115B - BB115C - MB17D - MB17C - MB16A - MB18 /M /B - MB20A /B /C - MD3B - MD17D - MD17C - MD20B -	29470-2531/ 9900/ 29470-2231C/ 29470-1231/ 6490-246/ 9400	F4B-9-10-35098-2
16.00149	ST149	MD 22 - M 22L	29500-1001	
16.00036	PM36	MD47A /C - MD96B - TAMD96B - TMD96B - 1113BR	52080-2001/ 9710-200	F7B-3000-10-24209-1

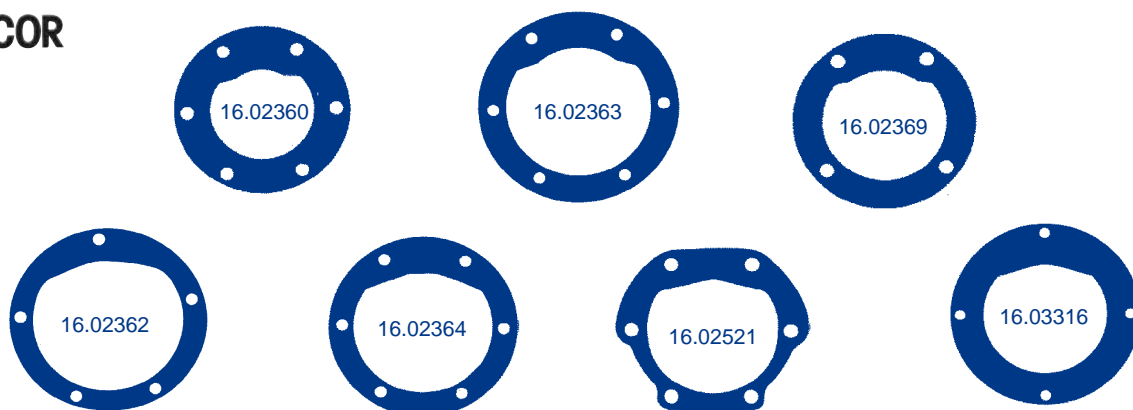

Guarnizioni in carta per pompe

Articolo	per pompe articolo
16.02360	16.00212
16.02362	16.00040 - 16.00240
16.02363	16.00036 - 16.00236 - 16.00146 - 16.00150
16.02364	16.00140 - 16.00149 - 16.00143
16.02369	16.00114
16.02521	16.00134 - 16.00135
16.03316	16.16112 - 16.16114 - 16.16400 16.16402 - 16.16404