

Grillo dritto in acciaio zincato a caldo

Articolo	Ø mm.	A	B	C
04.04005	5	19	9	31
04.04006	6	25	12	40
04.04008	8	30	16	51
04.04010	10	39	19	63
04.04012	12	50	24	80
04.04014	14	55	28	86
04.04016	16	64	31	102
04.04019	20	75	38	120
04.04022	22	88	43	140
04.04025	25	92	47	156
04.04028	28	115	57	171
04.04032	32	130	64	189

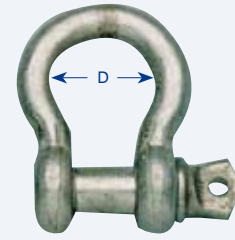

Grillo a cetra in acciaio zincato a caldo

Articolo	Ø mm.	A	B	C	D
04.04035	5	20	9	32	17
04.04036	6	26	14	41	21
04.04038	8	33	16	52	24
04.04040	10	36	19	61	29
04.04042	12	50	26	78	40
04.04044	14	60	28	92	47
04.04046	16	66	31	105	51
04.04050	20	80	35	128	57
04.04055	25	87	44	137	75
04.04060	32	115	57	189	100
04.04068	38	155	75	230	115



Grillo dritto in acciaio inox AISI 316

Articolo	Ø mm.	A	B	C
04.04104	4	15	8	25
04.04105	5	18	11	30
04.04106	6	21	12	36
04.04108	8	29	16	48
04.04110	10	36	22	60
04.04112	12	42	25	70
04.04114	14	48	28	83
04.04116	16	55	34	94
04.04119	20	67	38	113
04.04122	22	76	46	130



Grillo dritto lungo in acciaio inox AISI 316

Articolo	Ø mm.	A	B	C
04.04204	4	32	8	40
04.04205	5	40	10	51
04.04206	6	48	12	61
04.04208	8	64	16	82
04.04210	10	80	20	100



Grillo dritto extralarge in acciaio inox AISI 316

Articolo	Ø mm.	A	B
04.01306	6	36	24
04.01308	8	48	32
04.01310	10	60	40

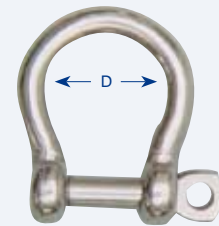

Grillo a cetra in acciaio inox AISI 316

Articolo	Ø mm.	A	B	C	D
04.04304	4	16	8	29	14
04.04305	5	20	10	32	17
04.04306	6	24	12	40	21
04.04308	8	32	16	54	28
04.04310	10	40	20	66	35
04.04312	12	48	24	70	42
04.04314	14	56	28	80	49
04.04316	16	64	32	90	56
04.04319	19	76	38	109	66

 Grillo con **perno incassato** per ancore in acciaio inox **AISI 316**

Articolo	Ø mm.	A	B	C
04.04404	4	16	8	25
04.04405	5	20	10	29
04.04406	6	24	12	35
04.04408	8	32	16	47
04.04410	10	40	20	60
04.04412	12	48	24	70

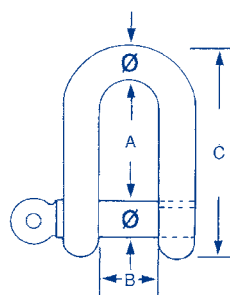
 Grillo storto in acciaio inox **AISI 316**

Articolo	Ø mm.	A	B	C
04.04504	4	24	8	40
04.04505	5	30	10	50
04.04506	6	36	12	55
04.04508	8	48	16	78
04.04510	10	60	20	95

 Grillo con **perno imperdibile** a vite in acciaio inox **AISI 316**

Articolo	Ø mm.	A	B	C
04.01004	4	16	8	28
04.01005	5	20	10	33
04.01006	6	24	12	40
04.01008	8	32	16	53
04.01010	10	40	20	64
04.01012	12	48	24	83

 Grillo dritto in lastra stampata in **acciaio inox**

Articolo	Ø mm.	A	B	C
04.04704	4	15	10	23
04.04705	5	17	12	28
04.04706	6	23	16	36

 Grillo lungo in lastra stampata in **acciaio inox**

Articolo	Ø mm.	A	B	C
04.04805	5	36	16	42
04.04806	6	40	16	55
04.04808	8	42	18	60

 Grillo con chiusura a scatto e **perno imperdibile** in lastra stampata in **acciaio inox**

Articolo	Ø mm.	A	B	C
04.04904	4	20	11	28
04.04905	5	36	15	46
04.04906	6	40	15	54

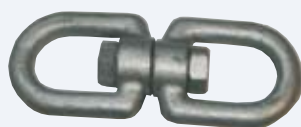
 Girella occhio + occhio in **acciaio zincato a caldo**

Articolo	Ø mm.	A	B	C
04.04910	10	128	34	31
04.04912	13	165	48	36

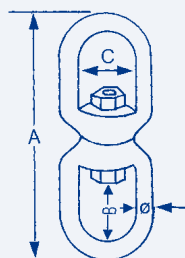
 Girella occhio + occhio in acciaio inox **AISI 316**

Articolo	Ø mm.	A	B	C
04.04926	6	65	15	15
04.04928	8	90	22	20
04.04930	10	115	27	24
04.04932	13	154	35	32

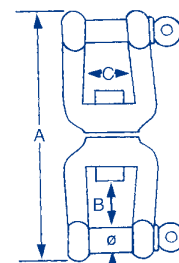
 Girella grillo + grillo in **acciaio inox**

Articolo	Ø mm.	A	B	C
04.04936	6	66	12	12
04.04938	8	94	16	16
04.04940	10	118	22	20
04.04942	13	152	28	26