

ANODI PROTEZIONE CATODICA

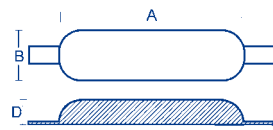

Anodi da saldare

Articolo	A	B	D	Kg
26.26001	110	63	26	1,0
26.26002	200	70	25	1,8
26.26006	215	70	29	2,2
26.26007	165	100	42	3,0



26.26007

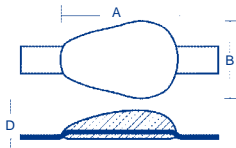

Anodi rettangolari per flaps

Articolo	A	B	C	D	Kg
26.26010	73	48	50	10	0,330
26.26013	110	67	57	20	0,970
26.26016	130	50	77	17	0,685
26.26018	190	54	76	24	1,450

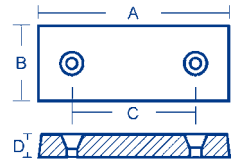

Anodi ovali

Articolo	A	B	C	D	Kg
26.26027	150	60	80	25	0,970
26.26028	240	65	140	29	2,300
26.26020	290	55	200	30	2,700

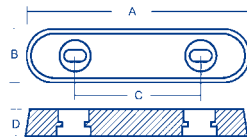

Anodo Fair Line

Articolo	A	B	C	D	Kg
26.26040	200	65	110 tot.	32	1,3
26.26041	320	65	110-210	35	2,2
26.26042	455	90	230	40	7,0

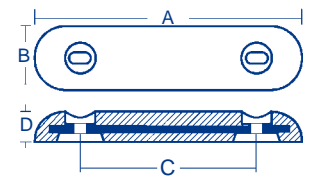

Flangia tonda per timoni

Articolo	Ø mm.	foro Ø mm.
26.26050	50	6,5
26.26051	70	8,5
26.26052	90	8,5
26.26053	110	10,5
26.26055	125	11,5
26.26054	140	12,5

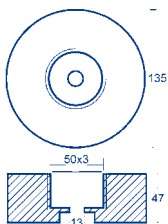

26.26065

Anodo tondo per poppa Ø mm. 135 x 47, completo di bullone e tappo, kg. 4,300

26.26066 solo anodo, Ø mm. 135 x 47 kg. 3,950

Anodo tondo per poppa

26.26060

Ø mm. 120 x 35, kg. 2,800

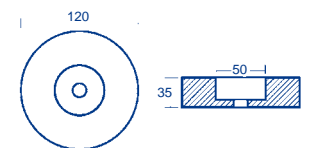

26.26064

Ø mm. 140 x 30, kg. 2,730

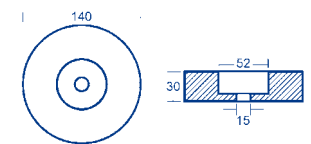

26.26072

Anodo ovale per flaps, mm. 85x40x15

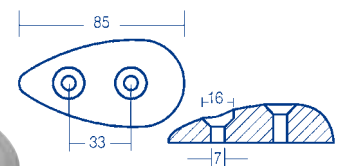

26.26073

Anodo ovale per flaps, mm. 145x40x20

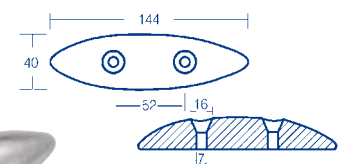

Ogiva linea asse elica tipo Radice, completa di ottone conico passo universale

Articolo	Ø asse mm.	Ø filetto mm.
26.26101	22-25	16x1,5
26.26102	30	20x1,5
26.26103	35	24x2
26.26104	40	24x2
26.26105	45	33x2
26.26106	50	36x3
26.26108	55	40x3
26.26107	60	45x3



Anodo ricambio ogiva asse elica tipo Radice, inserto conico, chiave laterale.

Articolo	Ø asse mm.	A	B	H
26.26110	22-25	33	25	39
26.26111	30	42	32	53
26.26112	35	46	38	61
26.26113	40	51	42	68
26.26114	45	61	48	76
26.26115	50	73	57	84
26.26117	55	75	65	87
26.26116	60-70-80-90	82	71	98
26.26118	100	98	84,5	98

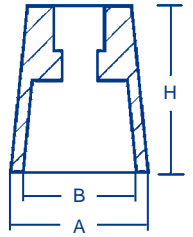

Anodo ricambio ogiva asse elica tipo Radice, inserto esagonale, chiave laterale.

Articolo	Ø asse mm.	A	B	H
26.26133	22-25	34	22	39
26.26134	30	43	27	53
26.26135	35	46	32	62
26.26136	40	52	36	67
26.26137	45	61	41	76
26.26138	50	73	46	84
26.26126	55	75	50	87
26.26139	60	82	55	98

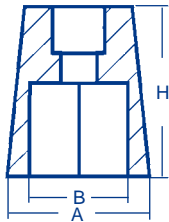

Rondella di fermo inox ogiva tipo Radice.

Articolo	Ø asse mm.	A	B
26.26091	22-25	38	17
26.26092	30	46	20
26.26093	35	51	24
26.26094	40	53	24
26.26095	45	66	33
26.26096	50	76	37
26.26098	55	81	40
26.26097	60	90	45

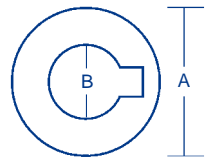

Ogiva linea asse elica Riva completa di ottone conico

Articolo	Ø asse mm.	Ø filetto mm.	A mm.	H mm.
26.26120	22	16x1,5	38	65
26.26121	25	18x1,5	38	65
26.26122	30	20x1,5	38	65
26.26123	35	24x2	52	88
26.26124	40	26x2	52	88
26.26125	45	30x2	52	88

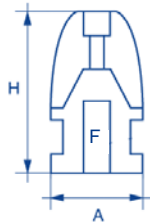

Anodo di ricambio ogiva asse elica Riva

Articolo	asse mm.	A mm.	H mm.
26.26127	20-25-30	38	37
26.26128	35-40	52	59
26.26129	45	52	59

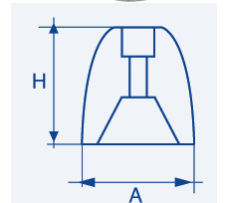

Anodo di ricambio per ogiva con inserto orizzontale

Articolo	asse mm.	Ø	Ø 1	Ø 2	h
26.26130	20-22-25-30	38	29	8	38
26.26131	35-40	52	40	8	50
26.26132	45	66	46	8	73

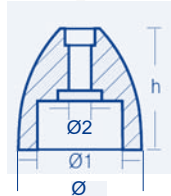

26.26079 Anodo sospeso completo di mt. 4,5 cavo inox rivestito in PCV e terminale per collegamento elettrico. Dim. mm. Ø 80 x 105 h. Peso kg. 2,5

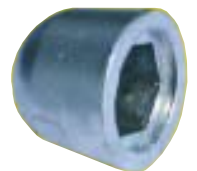
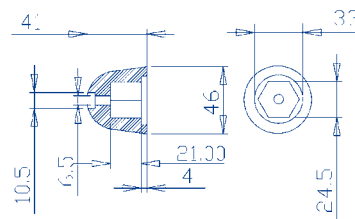
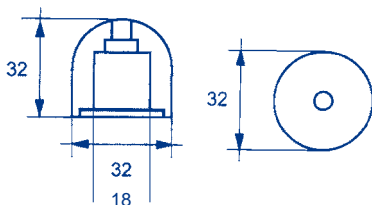

26.26198 Ogiva per Bow Trust MAX POWER

26.26199 Ogiva per Bow Trust SIDE POWER

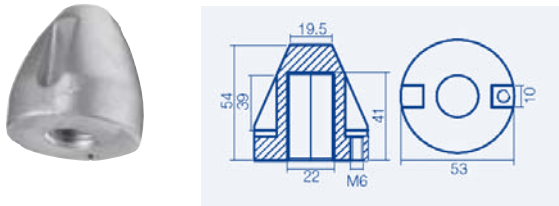

26.26620
Ogiva bow thrust SIDE POWER serie AZ



26.26621
Ogiva bow thrust SLEIPNER SP125 (rif. or. 101180)



26.26622
Ogiva bow thrust SLEIPNER SP55/75/95 (rif. or. 71190/51180)

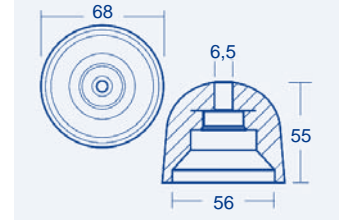

26.26623
Ogiva bow thrust VETUS

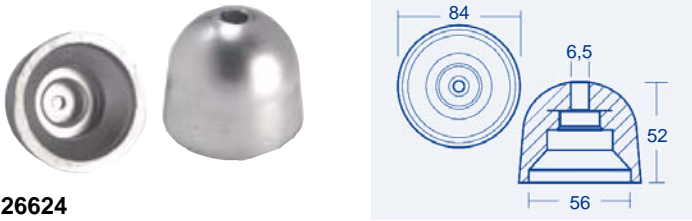

26.26624
Ogiva bow thrust VETUS

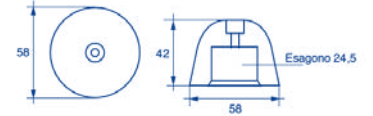

26.26625
Ogiva esagonale bow thrust VETUS

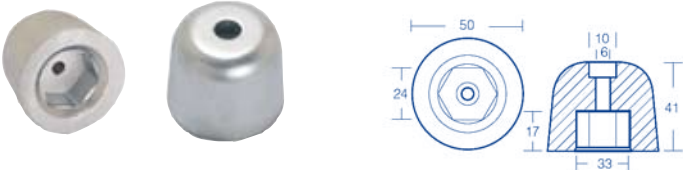

26.26626
Ogiva esagonale bow thrust VETUS (rif. or. BP1210)

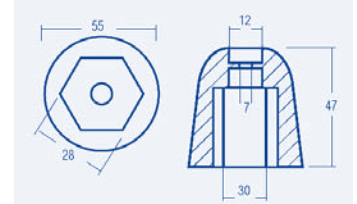

26.26627
Ogiva esagonale bow thrust VETUS

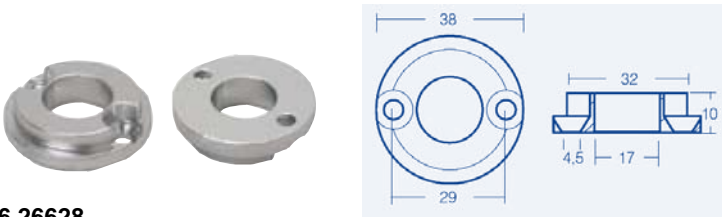

26.26628
Piastrina per bow thrust VETUS serie KGF25 (rif. or. BP1221)

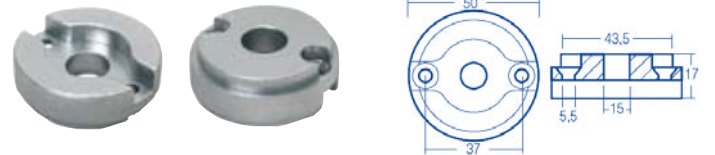

26.26629
Piastrina per bow thrust VETUS serie KGF35/55 (rif. or. BP1126)

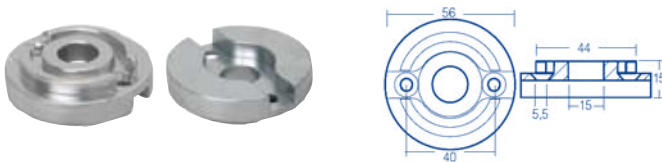

26.26630
Piastrina per bow thrust VETUS serie KGF75/95 (rif. or. BP1185)

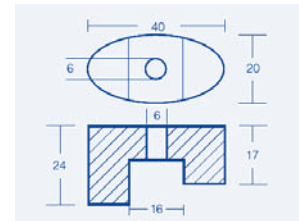

26.26631
Piastrina per bow thrust VETUS serie KW3 (rif. or. BP129)



Ogive per bow thrust LEWMAR

Articolo	Tipo	A	B	C	D	H	ref. or.
26.26632	S serie 140	38	25	18	9	13	589150
26.26633	M serie 185	46	33	24	11	15	589350
26.26634	L serie 250/300	62	45	34	17	18	589550



Collare per assi elica

Articolo	Ø asse mm.	H
26.26140	20	56
26.26141	25	56
26.26142	30	56
26.26143	32	56
26.26144	35	66
26.26145	38	66
26.26146	40	80
26.26147	45	80
26.26148	50	88
26.26152	55	88
26.26149	60	100

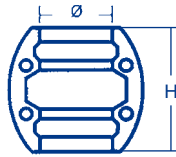

Collare per assi elica

Articolo	Ø asse mm.	H
26.26150	70	107
26.26151	75	107
26.26154	90	112

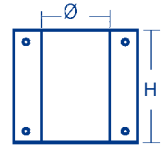

Anulare basso per assi elica dove lo spazio è molto limitato

Articolo	Ø asse mm.	H
26.26162	20	18
26.26163	25	18
26.26164	30	18
26.26165	35	18
26.26166	40	20
26.26167	45	20

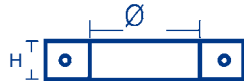

Ogiva max prop

Articolo	Ø mm.	A	H
26.26170	65	38	42
26.26171	72	42	43
26.26172	84	46	60
26.26173	100	52	61
26.26174	120	81	78

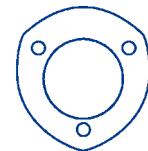

Collare max prop

Articolo	Ø mm.	A	H
26.26177	92	42	25
26.26178	92	46	25



Anodo a barre tonde, lunghezza mm. 400

Articolo	Ø mm.
26.26080	10
26.26084	14
26.26086	16
26.26088	18
26.26090	20



Anodi per scambiatori

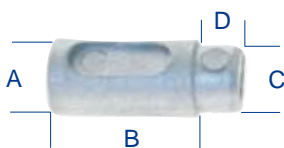

Aifo	A Ø	B	C	D
26.26180 (821)	14	26	Ø 12	8
26.26181 (828)	20	20	Ø 14	11
26.26182	10	23	Ø 4,5	8
26.26183	10	18	Ø 7	8
26.26184	13	26	Ø 10	8

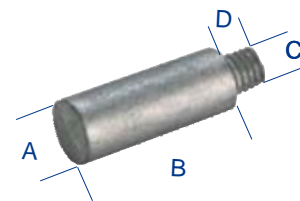

BUKH	VM	A Ø	B	C	D
26.26195		12	35	5MA	12
	26.26190	14	40	8MA	10
	26.26191	14	20	8MA	10
	26.26192	14	20	10MA	10