



## Musoni di prua in alluminio anodizzato

- PRODUZIONE CERTIFICATA A NORME ISO-UNI -  
- Idoneità R.I.Na. n° MSC/128198 -  
UNI - 3057 - 3058 - 3059 - 10681



Per gommoni e piccole imbarcazioni

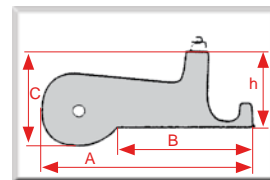

| Articolo        | Lungh. | Base    | Passaggio cavo |
|-----------------|--------|---------|----------------|
| <b>02.02074</b> | 132    | 90 x 87 | Ø mm. 18       |

Per ancore varie fino a Kg. 10

| Articolo        | A   | B   | C  | Largh. | h  |
|-----------------|-----|-----|----|--------|----|
| <b>02.04070</b> | 200 | 107 | 82 | 78     | 75 |

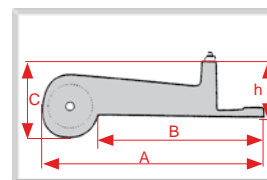
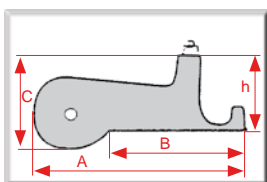

Per ancore varie fino a Kg. 12

| Articolo        | A   | B   | C   | Largh. | h  |
|-----------------|-----|-----|-----|--------|----|
| <b>02.03010</b> | 235 | 145 | 100 | 60     | 75 |

| Articolo        | ancora kg | A   | B   | C   | Largh. | h  |
|-----------------|-----------|-----|-----|-----|--------|----|
| <b>02.03122</b> | 18-20     | 325 | 235 | 110 | 76     | 91 |

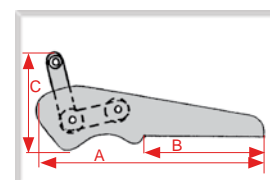
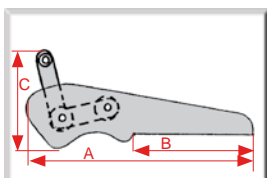

Per ancore varie fino a Kg. 10

| Articolo        | A   | B   | C   | Largh. |
|-----------------|-----|-----|-----|--------|
| <b>02.04162</b> | 330 | 174 | 220 | 90     |

Per ancore varie fino a Kg. 12

| Articolo        | A   | B   | C   | Largh. |
|-----------------|-----|-----|-----|--------|
| <b>02.04071</b> | 425 | 162 | 225 | 95     |

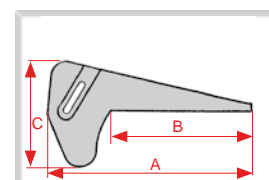
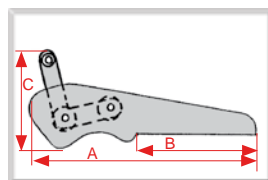

Per ancore tipo Bruce - Force - Danforth da kg 5 - 7,5 - 10

| Articolo        | A   | B   | C   | Largh. |
|-----------------|-----|-----|-----|--------|
| <b>02.04060</b> | 375 | 260 | 196 | 72     |

Per ancore varie fino a Kg. 15

| Articolo        | A   | B   | C   | Largh. |
|-----------------|-----|-----|-----|--------|
| <b>02.04072</b> | 535 | 295 | 240 | 135    |

Per ancore tipo Bruce - Force - Danforth da kg 15 - 20

| Articolo        | A   | B   | C   | Largh. |
|-----------------|-----|-----|-----|--------|
| <b>02.04160</b> | 550 | 375 | 260 | 78     |



## Musoni di prua in alluminio anodizzato

- PRODUZIONE CERTIFICATA A NORME ISO-UNI -  
 - Idoneità R.I.Na. n° MSC/128198 -  
 UNI - 3057 - 3058 - 3059 - 10681

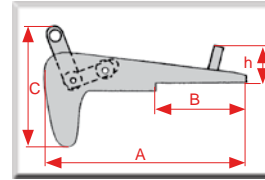
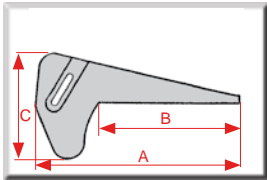



Per ancore tipo Delta - Plough da kg 12

| Articolo        | A   | B   | C   | Largh. |
|-----------------|-----|-----|-----|--------|
| <b>02.04169</b> | 460 | 290 | 220 | 70     |

Per ancore tipo Bruce - Force - Danforth da kg. 5 - 7,5 - 10

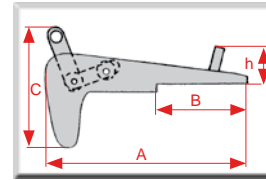
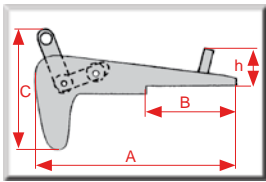
| Articolo        | A   | B   | C   | Largh. | h  |
|-----------------|-----|-----|-----|--------|----|
| <b>02.04063</b> | 380 | 180 | 315 | 100    | 88 |



Per ancore tipo Bruce - Force - Danforth da kg. 5 - 7,5 - 10

| Articolo        | A   | B   | C   | Largh. | h   |
|-----------------|-----|-----|-----|--------|-----|
| <b>02.04064</b> | 390 | 255 | 270 | 89     | 136 |

Per ancore tipo Bruce - Force - Danforth da kg. 5 - 7,5 - 10

| Articolo        | A   | B   | C   | Largh. | h   |
|-----------------|-----|-----|-----|--------|-----|
| <b>02.04163</b> | 380 | 180 | 315 | 100    | 149 |

02.04018



02.04019/20



02.04022

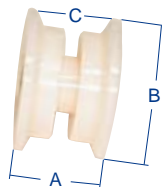

Rullo di ricambio per musoni di prua.

| Articolo        | A    | B  | C    |
|-----------------|------|----|------|
| <b>02.04018</b> | 33   | 70 | 22,5 |
| <b>02.04019</b> | 43,5 | 70 | 27,5 |
| <b>02.04020</b> | 43,5 | 70 | 37   |
| <b>02.04022</b> | 52   | 78 | 35   |



Fermo di ricambio  
**02.04014** per art. 02.03010  
**02.04013** per art. 02.03012



**02.04015**  
 Fermo per ancore da  
 abbinare all'art. 02.04062  
 Base mm. 120x70  
 Altezza mm. 65 pomello escluso



**02.04016**  
 Fermo per ancore  
 Base mm. 105x96  
 Altezza mm. 87 pomello  
 escluso



**02.04017**  
 Fermo per ancore  
 Base mm. 76x73  
 Altezza mm. 137 pomello  
 escluso



**03.03060**  
 Passacima per ancora in ottone cromato chiusura con galletti,  
 ingombro totale Ø mm. 155.

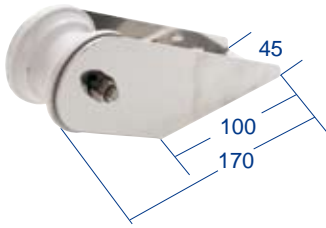

**03.03017**  
Musone di prua in acciaio inox con puleggia in nylon.

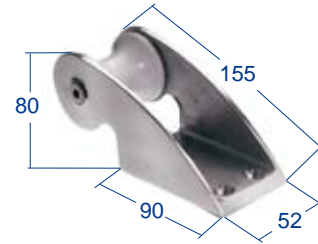

**03.03014**  
Musone di prua in acciaio inox con puleggia in nylon per canotti pneumatici e piccole imbarcazioni.

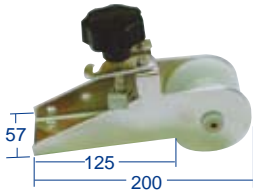

**03.03054**  
Musone di prua in acciaio inox con puleggia in nylon e arresto per ancora.



Musone modello basculante in acciaio inox.

| Articolo        | Lung. mm. | Larg. mm. | Ancore Kg. |
|-----------------|-----------|-----------|------------|
| <b>03.03016</b> | 280       | 80        | 10         |
| <b>03.03018</b> | 340       | 80        | 12         |
| <b>03.03021</b> | 400       | 80        | 15         |

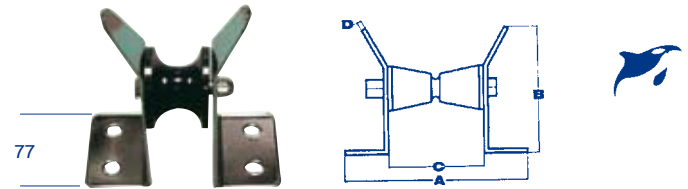
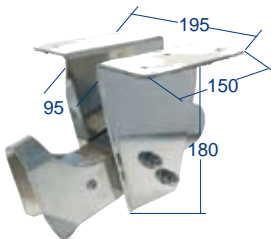

Musone modello fisso in acciaio inox per montaggio ad incasso nella delfiniera.

| Articolo        | Rullo Ø mm | A   | B   | C  | D |
|-----------------|------------|-----|-----|----|---|
| <b>03.03023</b> | 63         | 146 | 150 | 44 | 3 |
| <b>03.03024</b> | 76         | 190 | 150 | 88 | 4 |

**03.03020**  
Musone modello basculante in acciaio inox per montaggio ad incasso nella delfiniera.

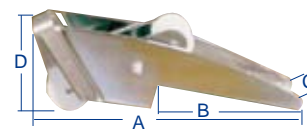
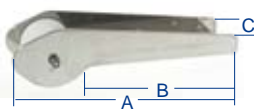

Musone modello fisso in acciaio inox

| Articolo        | Ancore Kg. | A   | B   | C  |
|-----------------|------------|-----|-----|----|
| <b>03.03055</b> | 10         | 240 | 150 | 67 |
| <b>03.03057</b> | 12         | 330 | 225 | 67 |

Musone modello basculante in acciaio inox

| Articolo        | Ancore Kg. | A   | B   | C  | D   |
|-----------------|------------|-----|-----|----|-----|
| <b>03.03059</b> | 10-20      | 416 | 230 | 80 | 145 |
| <b>03.03065</b> | 25-30      | 590 | 390 | 80 | 145 |

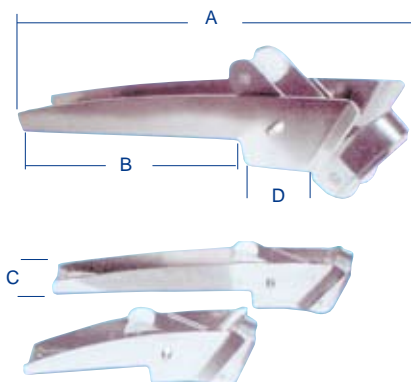

Musone modello basculante in acciaio inox per ancore Bruce, Force, Delta, Shark e Holding

| Articolo        | Ancore Kg. | A   | B   | C   | D   |
|-----------------|------------|-----|-----|-----|-----|
| <b>03.03030</b> | 15         | 420 | 230 | 78  | 80  |
| <b>03.03031</b> | 20         | 610 | 395 | 80  | 90  |
| <b>03.03032</b> | 30         | 770 | 510 | 90  | 110 |
| <b>03.03033</b> | 30         | 950 | 620 | 100 | 150 |

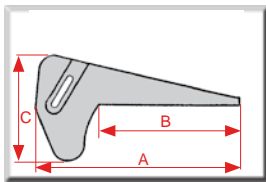

Musone in acciaio inox per ancore tipo Bruce e Force  
Modello fisso

| Articolo        | Ancore Kg. | A   | B   | C   | D  |
|-----------------|------------|-----|-----|-----|----|
| <b>03.03047</b> | 5-7,5-10   | 370 | 250 | 190 | 70 |
| <b>03.03049</b> | 15-20-30   | 540 | 370 | 250 | 85 |

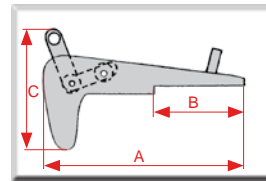

Musone in acciaio inox per ancore tipo Bruce e Force  
Modello basculante

| Articolo        | Ancore Kg. | A   | B   | C   | D  |
|-----------------|------------|-----|-----|-----|----|
| <b>03.03048</b> | 5-7,5-10   | 390 | 165 | 190 | 80 |
| <b>03.03050</b> | 15-20-30   | 550 | 250 | 250 | 95 |



Fermo per ancore in acciaio inox

| Articolo        | per art.                   | A  | B  | C   |
|-----------------|----------------------------|----|----|-----|
| <b>03.03061</b> | 03.03055/57/47             | 58 | 58 | 80  |
| <b>03.03062</b> | 03.03018/48/59<br>65/16/21 | 68 | 55 | 82  |
| <b>03.03063</b> | 03.03049/50                | 82 | 55 | 118 |

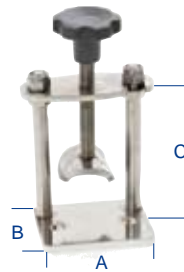

Scudo di prua in acciaio inox **AISI 316** lucidato a specchio. Ideale per proteggere la prua della barca al momento in cui si salpa l'ancora.

**03.03070** h. 520 - Lung. 350  
**03.03071** h. 680 - Lung. 450

